

309-31 Reliance Ct New Westminster, BC

Main Floor	964 SQ.FT.
Balcony	102 SQ.FT.

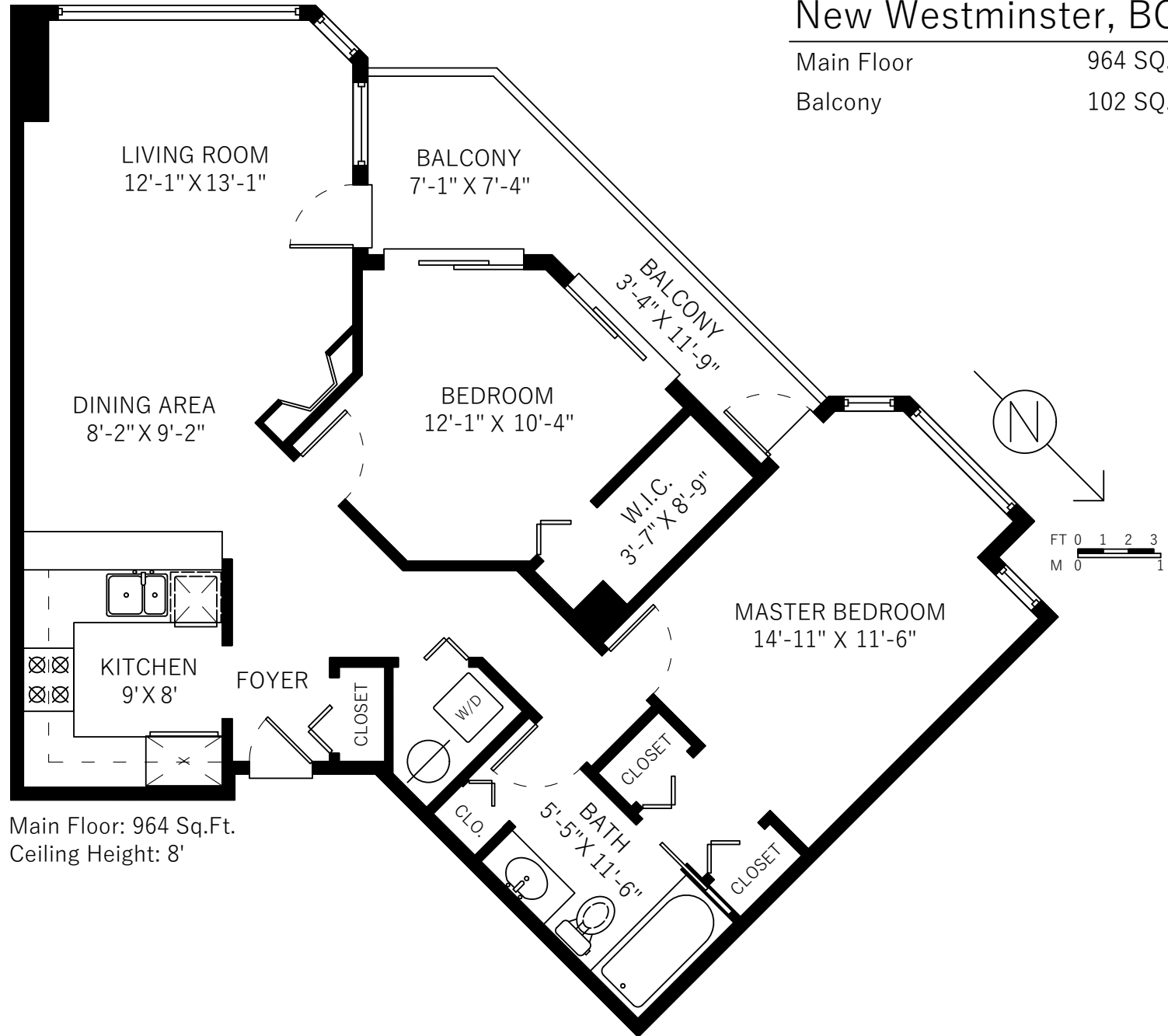

Main Floor: 964 Sq.Ft.
 Ceiling Height: 8'

Floor plan not suitable for architectural/construction purposes. ANSI Z765 standard used to calculate square footage. Buyer to verify.